

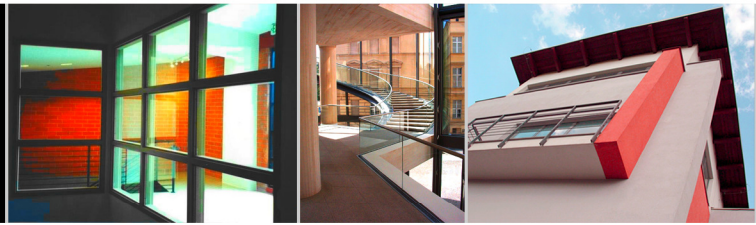

**FOUQUETTE**  
Commercial Real Estate Services



www.fouquette.com

## 8737 VENICE BLVD.– LOS ANGELES, CALIFORNIA

### FOR LEASE

#### Creative Office Suite ideal for 2 to 4 people

- **Suite 100 - \$1,100/Mo. FSG** (Includes Janitorial & utilities)
- Air-Conditioning and operable windows
- Additional conference room use
- 24/7 building access and Secure building



- Free parking
- **Have you had the burger at Father's Office? (it's across the street)**
- Nicely manicured landscaping
- **Walking distance to the upscale sidewalk eateries at the Helms Bakery & downtown Culver City.**
- Ready to move in condition
- Within 7 miles to LAX, Santa Monica, Century City, Beverly Hills & Downtown Los Angeles
- Immediate access to the 10-FWY
- **AVAILABLE SOON**



**FLOYD FOUQUETTE**

DRE Lic. 01092388

floyd@fouquette.com

The information contained herein is given in confidence with the understanding that all negotiations pertaining to this property shall be handled through Fouquette Commercial Real Estate Services.

This information has been furnished from sources which we deem reliable and for which we assume no liability. All measurements are approximate.

8737 Venice Boulevard, 2<sup>nd</sup> FL. Los Angeles, CA 90034 Phone: 310/202-1280

Fax: 310/202-1284 www.fouquette.com